

ABSTELLPLÄTZE UND INS-BEZUGSPUNKTE
PARKING POSITIONS AND INS REFERENCE POINTS

MÜNSTER/OSNABRÜCK

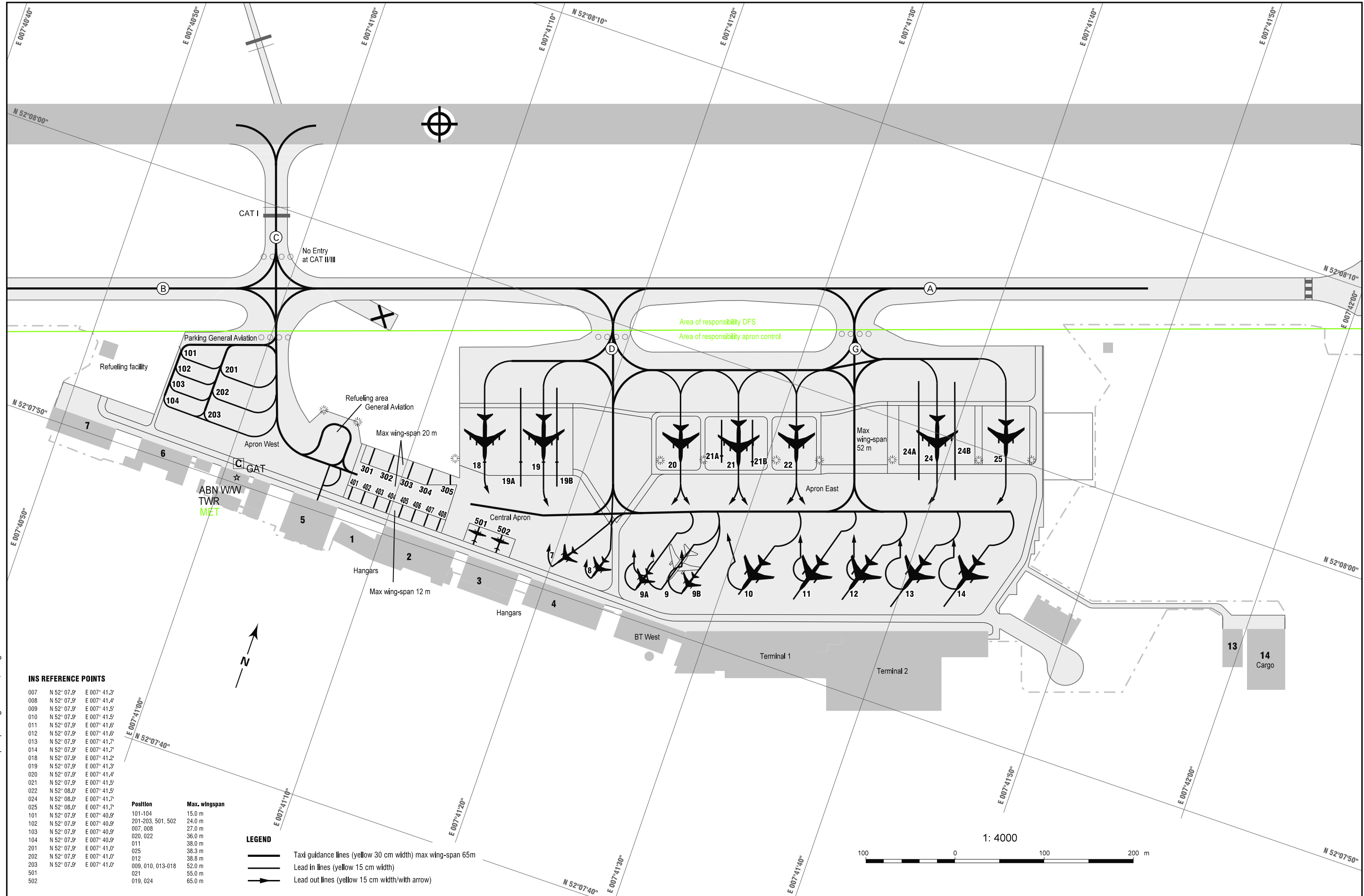

INS REFERENCE POINTS

007	N 52° 07.9'	E 007° 41.3'
008	N 52° 07.9'	E 007° 41.4'
009	N 52° 07.9'	E 007° 41.5'
010	N 52° 07.9'	E 007° 41.5'
011	N 52° 07.9'	E 007° 41.6'
012	N 52° 07.9'	E 007° 41.6'
013	N 52° 07.9'	E 007° 41.7'
014	N 52° 07.9'	E 007° 41.7'
018	N 52° 07.9'	E 007° 41.2'
019	N 52° 07.9'	E 007° 41.3'
020	N 52° 07.9'	E 007° 41.4'
021	N 52° 07.9'	E 007° 41.5'
022	N 52° 08.0'	E 007° 41.5'
024	N 52° 08.0'	E 007° 41.7'
025	N 52° 08.0'	E 007° 41.7'
101	N 52° 07.9'	E 007° 40.9'
102	N 52° 07.9'	E 007° 40.9'
103	N 52° 07.9'	E 007° 40.9'
104	N 52° 07.9'	E 007° 40.9'
201	N 52° 07.9'	E 007° 41.0'
202	N 52° 07.9'	E 007° 41.0'
203	N 52° 07.9'	E 007° 41.0'
501	N 52° 07.9'	E 007° 41.0'
502	N 52° 07.9'	E 007° 41.0'

Position	Max. wingspan
101-104	15.0 m
201-203, 501, 502	24.0 m
007, 008	27.0 m
020, 022	36.0 m
011	38.0 m
025	38.3 m
012	38.8 m
009, 010, 013-018	52.0 m
021	55.0 m
019, 024	65.0 m

LEGEND

- Taxi guidance lines (yellow 30 cm width) max wing-span 65m
- Lead in lines (yellow 15 cm width)
- Lead out lines (yellow 15 cm width/with arrow)

Correction: Helicopter parking removed, hangar 6.