

KARTE DER LUFTFAHRZEUG-PARKPOSITIONEN - ICAO
AIRCRAFT PARKING/DOCKING CHART - ICAO

HAMBURG

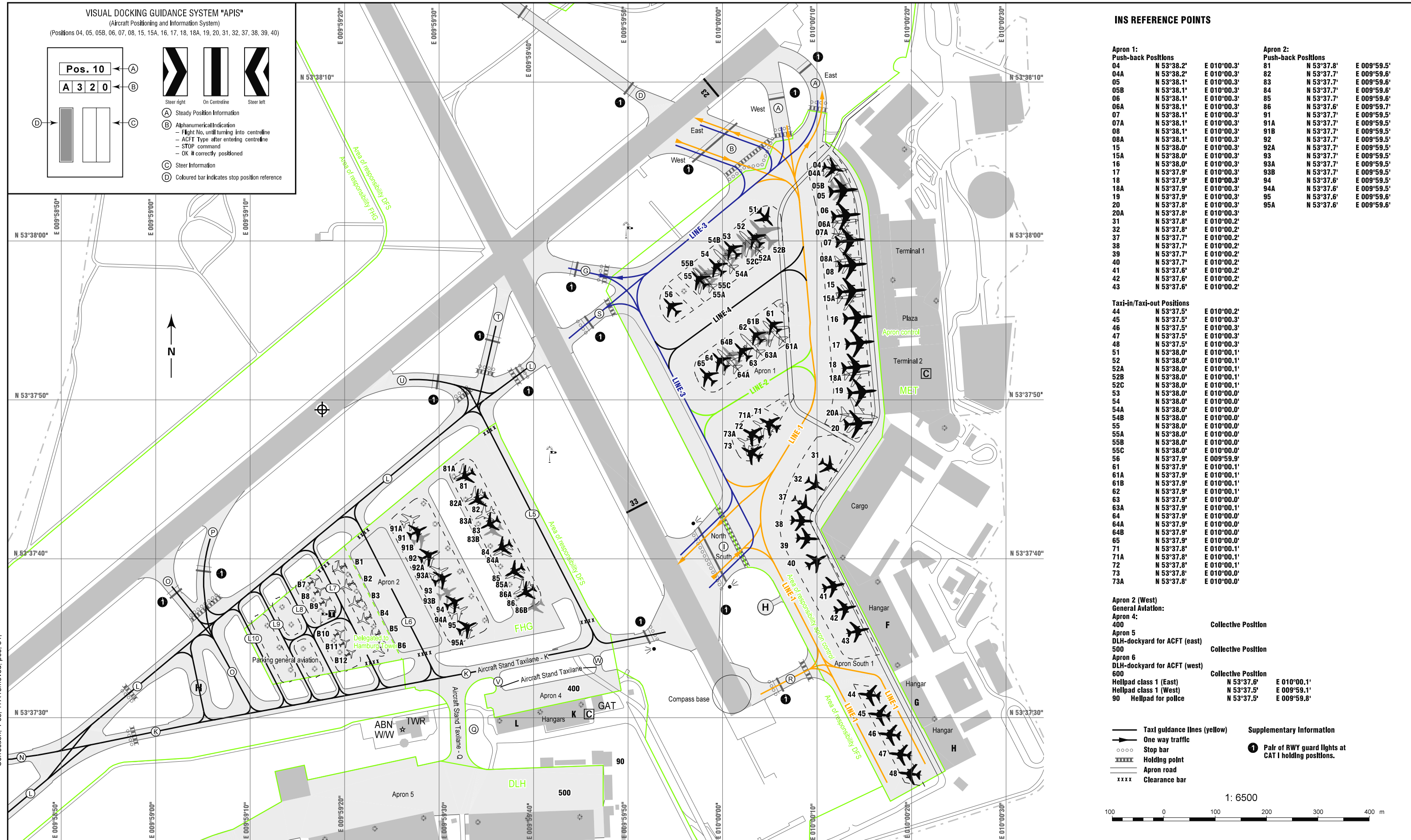

INS REFERENCE POINTS

Apron 1: Push-back Positions		Apron 2: Push-back Positions	
04	N 53°38.2' E 010°00.3'	81	N 53°37.8' E 009°59.5'
04A	N 53°38.2' E 010°00.3'	82	N 53°37.7' E 009°59.6'
05	N 53°38.1' E 010°00.3'	83	N 53°37.7' E 009°59.6'
05B	N 53°38.1' E 010°00.3'	84	N 53°37.7' E 009°59.6'
06	N 53°38.1' E 010°00.3'	85	N 53°37.7' E 009°59.6'
06A	N 53°38.1' E 010°00.3'	86	N 53°37.6' E 009°59.7'
07	N 53°38.1' E 010°00.3'	91	N 53°37.7' E 009°59.5'
07A	N 53°38.1' E 010°00.3'	91A	N 53°37.7' E 009°59.5'
08	N 53°38.1' E 010°00.3'	91B	N 53°37.7' E 009°59.5'
08A	N 53°38.1' E 010°00.3'	92	N 53°37.7' E 009°59.5'
15	N 53°38.0' E 010°00.3'	92A	N 53°37.7' E 009°59.5'
15A	N 53°38.0' E 010°00.3'	93	N 53°37.7' E 009°59.5'
16	N 53°38.0' E 010°00.3'	93A	N 53°37.7' E 009°59.5'
17	N 53°37.9' E 010°00.3'	93B	N 53°37.7' E 009°59.5'
18	N 53°37.9' E 010°00.3'	94	N 53°37.6' E 009°59.5'
18A	N 53°37.9' E 010°00.3'	94A	N 53°37.6' E 009°59.5'
19	N 53°37.9' E 010°00.3'	95	N 53°37.6' E 009°59.6'
20	N 53°37.8' E 010°00.3'	95A	N 53°37.6' E 009°59.6'
20A	N 53°37.8' E 010°00.3'		
31	N 53°37.8' E 010°00.2'		
32	N 53°37.8' E 010°00.2'		
37	N 53°37.7' E 010°00.2'		
38	N 53°37.7' E 010°00.2'		
39	N 53°37.7' E 010°00.2'		
40	N 53°37.7' E 010°00.2'		
41	N 53°37.6' E 010°00.2'		
42	N 53°37.6' E 010°00.2'		
43	N 53°37.6' E 010°00.2'		

Taxi-in/Taxi-out Positions	
44	N 53°37.5' E 010°00.2'
45	N 53°37.5' E 010°00.3'
46	N 53°37.5' E 010°00.3'
47	N 53°37.5' E 010°00.3'
48	N 53°37.5' E 010°00.3'
51	N 53°38.0' E 010°00.1'
52	N 53°38.0' E 010°00.1'
52A	N 53°38.0' E 010°00.1'
52B	N 53°38.0' E 010°00.1'
52C	N 53°38.0' E 010°00.1'
53	N 53°38.0' E 010°00.0'
54	N 53°38.0' E 010°00.0'
54A	N 53°38.0' E 010°00.0'
54B	N 53°38.0' E 010°00.0'
55	N 53°38.0' E 010°00.0'
55A	N 53°38.0' E 010°00.0'
55B	N 53°38.0' E 010°00.0'
55C	N 53°38.0' E 010°00.0'
56	N 53°37.9' E 009°59.9'
61	N 53°37.9' E 010°00.1'
61A	N 53°37.9' E 010°00.1'
61B	N 53°37.9' E 010°00.1'
62	N 53°37.9' E 010°00.1'
63	N 53°37.9' E 010°00.0'
63A	N 53°37.9' E 010°00.1'
64	N 53°37.9' E 010°00.0'
64A	N 53°37.9' E 010°00.0'
64B	N 53°37.9' E 010°00.0'
65	N 53°37.9' E 010°00.0'
71	N 53°37.8' E 010°00.1'
71A	N 53°37.8' E 010°00.1'
72	N 53°37.8' E 010°00.1'
73	N 53°37.8' E 010°00.0'
73A	N 53°37.8' E 010°00.0'

Apron 2 (West) General Aviation:	
Apron 4:	Collective Position
Apron 5	DLH-dockyard for ACFT (east)
500	Collective Position
Apron 6	DLH-dockyard for ACFT (west)
600	Collective Position
Helipad class 1 (East)	N 53°37.6' E 010°00.1'
Helipad class 1 (West)	N 53°37.5' E 009°59.1'
90	Helipad for police

Supplementary Information
 1 Pair of RWY guard lights at CAT I holding positions.

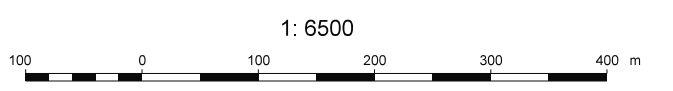

Correction: Pos. 17A removed, pos. 51.