

FLUGPLATZROLLKARTE - ICAO
AERODROME GROUND MOVEMENT CHART - ICAO

BERLIN-TEGEL

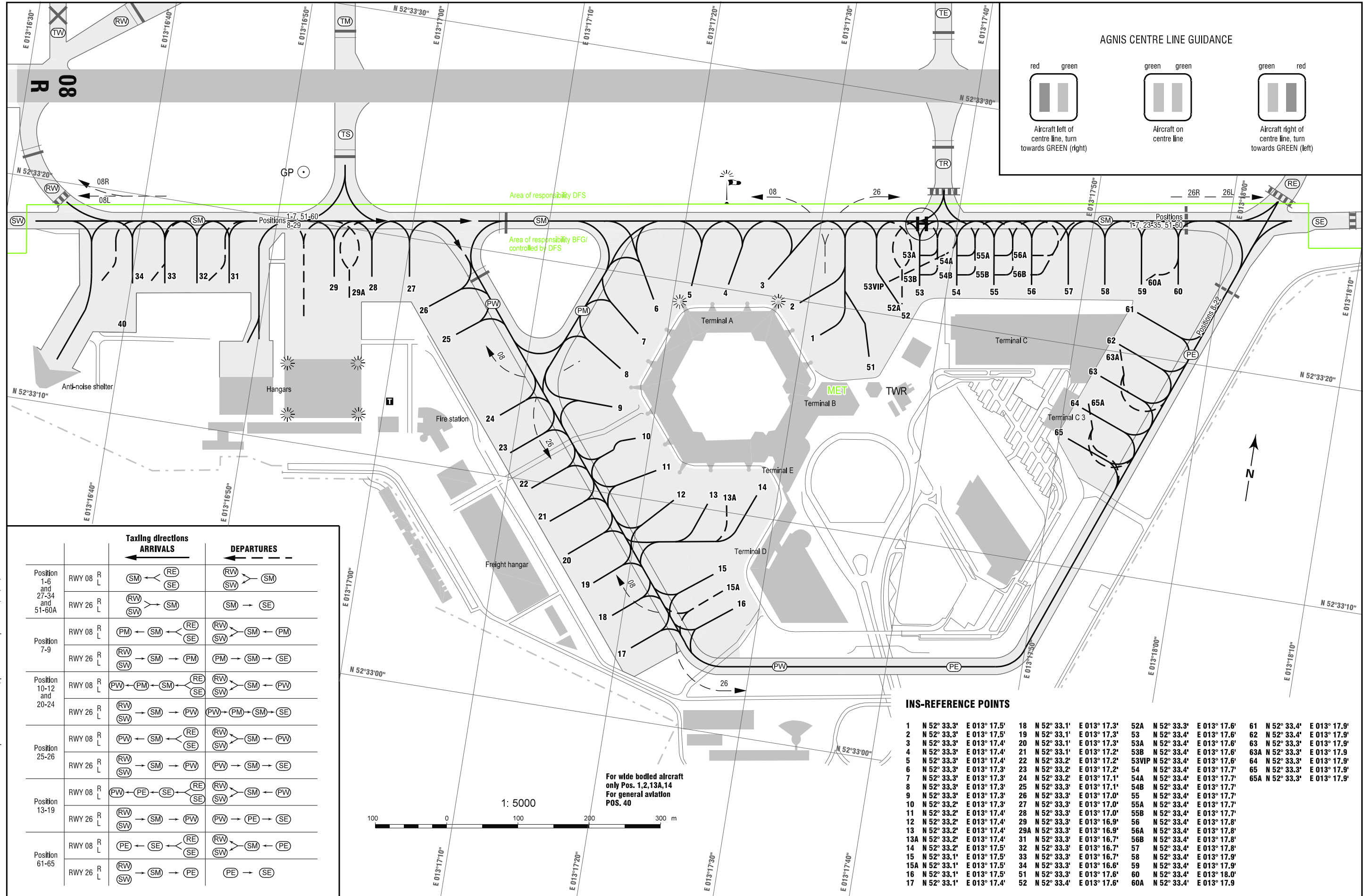

AGNIS CENTRE LINE GUIDANCE

red	green	green	green	green	red
[Light symbol]		[Light symbol]		[Light symbol]	
Aircraft left of centre line, turn towards GREEN (right)		Aircraft on centre line		Aircraft right of centre line, turn towards GREEN (left)	

Position	RWY	L	Taxiling directions	
			ARRIVALS	DEPARTURES
Position 1-6 and 27-34 and 51-60A	RWY 08	R	SM ← RE SE	RW → SM SW
	RWY 26	R	RW → SM SW	SM → SE
Position 7-9	RWY 08	R	PM ← SM ← RE SE	RW → SM ← PM SW
	RWY 26	R	RW → SM → PM SW	PM → SM → SE
Position 10-12 and 20-24	RWY 08	R	PW ← PM ← SM ← RE SE	RW → SM ← PW SW
	RWY 26	R	RW → SM → PW SW	PW → PM → SM → SE
Position 25-26	RWY 08	R	PW ← SM ← RE SE	RW → SM ← PW SW
	RWY 26	R	RW → SM → PW SW	PW → SM → SE
Position 13-19	RWY 08	R	PW ← PE ← SE ← RE SE	RW → SM ← PW SW
	RWY 26	R	RW → SM → PW SW	PW → PE → SE
Position 61-65	RWY 08	R	PE ← SE ← RE SE	RW → SM ← PE SW
	RWY 26	R	RW → SM → PE SW	PE → SE

INS-REFERENCE POINTS

1 N 52° 33.3' E 013° 17.5'	18 N 52° 33.1' E 013° 17.3'	52A N 52° 33.3' E 013° 17.6'	61 N 52° 33.4' E 013° 17.9'
2 N 52° 33.3' E 013° 17.5'	19 N 52° 33.1' E 013° 17.3'	53 N 52° 33.4' E 013° 17.6'	62 N 52° 33.4' E 013° 17.9'
3 N 52° 33.3' E 013° 17.4'	20 N 52° 33.1' E 013° 17.3'	53A N 52° 33.4' E 013° 17.6'	63 N 52° 33.3' E 013° 17.9'
4 N 52° 33.3' E 013° 17.4'	21 N 52° 33.1' E 013° 17.2'	53B N 52° 33.4' E 013° 17.6'	63A N 52° 33.3' E 013° 17.9'
5 N 52° 33.3' E 013° 17.4'	22 N 52° 33.2' E 013° 17.2'	53VIP N 52° 33.4' E 013° 17.6'	64 N 52° 33.3' E 013° 17.9'
6 N 52° 33.3' E 013° 17.3'	23 N 52° 33.2' E 013° 17.2'	54 N 52° 33.4' E 013° 17.7'	65 N 52° 33.3' E 013° 17.9'
7 N 52° 33.3' E 013° 17.3'	24 N 52° 33.2' E 013° 17.1'	54A N 52° 33.4' E 013° 17.7'	65A N 52° 33.3' E 013° 17.9'
8 N 52° 33.3' E 013° 17.3'	25 N 52° 33.3' E 013° 17.1'	54B N 52° 33.4' E 013° 17.7'	
9 N 52° 33.3' E 013° 17.3'	26 N 52° 33.3' E 013° 17.0'	55 N 52° 33.4' E 013° 17.7'	
10 N 52° 33.2' E 013° 17.3'	27 N 52° 33.3' E 013° 17.0'	55A N 52° 33.4' E 013° 17.7'	
11 N 52° 33.2' E 013° 17.4'	28 N 52° 33.3' E 013° 17.0'	55B N 52° 33.4' E 013° 17.7'	
12 N 52° 33.2' E 013° 17.4'	29 N 52° 33.3' E 013° 16.9'	56 N 52° 33.4' E 013° 17.8'	
13 N 52° 33.2' E 013° 17.4'	29A N 52° 33.3' E 013° 16.9'	56A N 52° 33.4' E 013° 17.8'	
13A N 52° 33.2' E 013° 17.4'	31 N 52° 33.3' E 013° 16.7'	56B N 52° 33.4' E 013° 17.8'	
14 N 52° 33.2' E 013° 17.5'	32 N 52° 33.3' E 013° 16.7'	57 N 52° 33.4' E 013° 17.8'	
15 N 52° 33.1' E 013° 17.5'	33 N 52° 33.3' E 013° 16.7'	58 N 52° 33.4' E 013° 17.9'	
15A N 52° 33.1' E 013° 17.5'	34 N 52° 33.3' E 013° 16.6'	59 N 52° 33.4' E 013° 17.9'	
16 N 52° 33.1' E 013° 17.5'	51 N 52° 33.3' E 013° 17.6'	60 N 52° 33.4' E 013° 18.0'	
17 N 52° 33.1' E 013° 17.4'	52 N 52° 33.4' E 013° 17.6'	60A N 52° 33.4' E 013° 17.9'	

Correction: INS ref. point 35 removed, position INS points 31, 32, 33, 34.