

Bearings are magnetic	TWR 118.975
Distances in metres	
Elevation in ft AMSL	
Coordinates WGS84	

APRON 1		APRON 2		APRON 3	
Lighting	Bearing strength	Lighting	Bearing strength	Lighting	Bearing strength
Edge: BLUE	Surface: CONCRETE Strength: PCN 49/R/C/W/T	Edge: BLUE	Surface: CONCRETE Strength: PCN 73/R/B/W/T	Edge: BLUE	Surface: CONCRETE/ASPHALT Strength: STAND 29-37 PCN 15/F/B/W/T Strength: STAND 39-51 PCN 50/R/B/W/T

APRON 1
POINTS ON PARKING AREA

STANDS	N	E
101	40°54'06,62"	009°30'54,61"
102	40°54'07,44"	009°30'56,29"
103	40°54'08,31"	009°30'57,78"
104	40°54'09,10"	009°30'59,35"
105	40°54'09,97"	009°31'00,90"
106	40°54'06,03"	009°31'04,30"
107	40°54'04,88"	009°31'01,92"
108	40°54'03,60"	009°30'59,64"
109	40°54'02,48"	009°30'57,33"
110	40°53'59,90"	009°30'52,43"
111	40°53'58,30"	009°30'49,43"
112	40°54'01,97"	009°30'45,63"
113	40°54'03,17"	009°30'47,92"
114	40°54'04,32"	009°30'50,38"
115	40°54'05,31"	009°30'52,17"
116	40°54'18,50"	009°31'06,50"
117	40°54'20,80"	009°31'10,30"
118	40°54'22,30"	009°31'13,30"
119	40°54'24,20"	009°31'15,80"
21	40°54'08,88"	009°31'07,73"
22	40°54'08,34"	009°31'08,26"
23	40°54'09,53"	009°31'09,02"
24	40°54'09,08"	009°31'09,50"
25	40°54'10,29"	009°31'10,03"
26	40°54'09,62"	009°31'10,83"
27	40°54'10,93"	009°31'11,68"
28	40°54'10,43"	009°31'03,50"

APRON 3

STANDS	N	E
29	40°54'14,43"	009°31'21,30"
30	40°54'14,43"	009°31'21,38"
31	40°54'14,00"	009°31'20,75"
32	40°54'13,76"	009°31'20,10"
33	40°54'13,00"	009°31'18,88"
34	40°54'13,44"	009°31'19,40"
35	40°54'13,76"	009°31'20,13"
36	40°54'14,00"	009°31'20,77"
37	40°54'14,43"	009°31'21,39"
39	40°54'17,83"	009°31'26,38"
40	40°54'18,53"	009°31'27,02"
41	40°54'18,57"	009°31'27,84"
42	40°54'18,97"	009°31'28,58"
43	40°54'19,33"	009°31'29,91"
44	40°54'19,71"	009°31'30,05"
45	40°54'20,11"	009°31'30,78"
46	40°54'19,20"	009°31'31,54"
47	40°54'18,83"	009°31'30,70"
48	40°54'18,55"	009°31'30,00"
49	40°54'18,12"	009°31'29,36"
50	40°54'17,78"	009°31'28,56"
51	40°54'17,37"	009°31'27,83"

CHANGE: Aircraft stands renamed

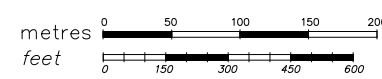
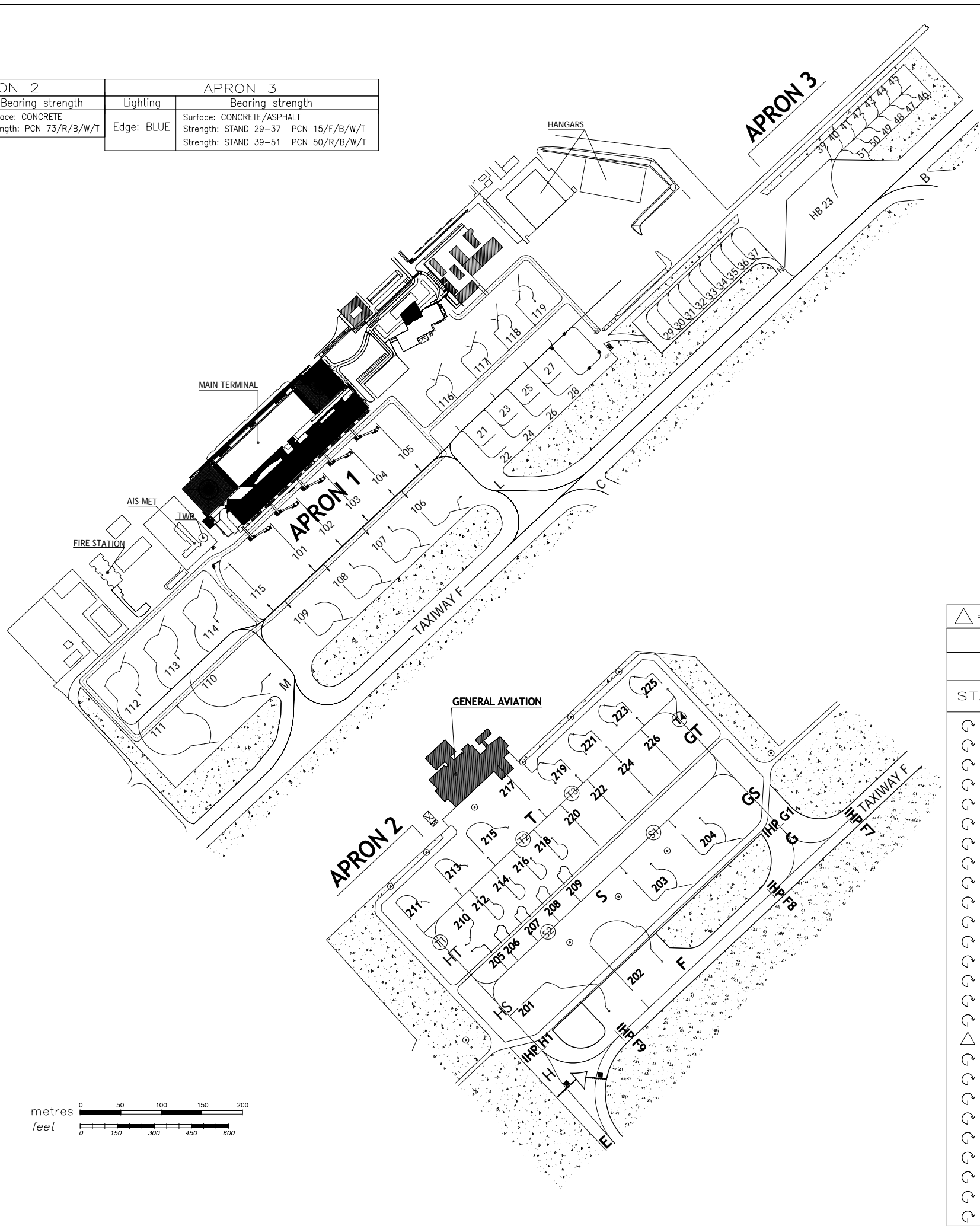

OLBIA / COSTA SMERALDA		
LIEO	40°53'55" N	009°31'04" E

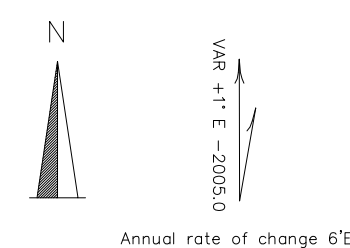

△ = PUSH-BACK ⤷ = SELF-MANOEUVRING

APRON 2

POINTS ON PARKING AREA

STAND	MAX ACFT ALLOWED	N	E
⤷ 201	B 767-300	40°53'40,54"	009°30'15,52"
⤷ 202	B 767-300	40°53'42,38"	009°30'18,96"
⤷ 203	B 737 - BBJ2	40°53'41,30"	009°30'21,90"
⤷ 204	B 737 - BBJ2	40°53'42,70"	009°30'24,52"
⤷ 205	CESSNA CITATIONJET	40°53'41,18"	009°30'12,58"
⤷ 206	CESSNA CITATIONJET	40°53'40,68"	009°30'13,51"
⤷ 207	CESSNA CITATIONJET	40°53'41,26"	009°30'14,59"
⤷ 208	CESSNA CITATIONJET	40°53'41,87"	009°30'15,74"
⤷ 209	CESSNA CITATIONJET	40°53'42,48"	009°30'16,89"
⤷ 210	FALCON 900 B	40°53'40,58"	009°30'12,18"
⤷ 211	GULFSTREAM V	40°53'42,11"	009°30'10,10"
⤷ 212	FALCON 900 B	40°53'41,19"	009°30'13,50"
⤷ 213	GULFSTREAM V	40°53'43,23"	009°30'12,20"
⤷ 214	FALCON 900 B	40°53'41,81"	009°30'14,65"
⤷ 215	B 737 - BBJ2	40°53'46,65"	009°30'13,14"
⤷ 216	FALCON 900 B	40°53'42,42"	009°30'15,79"
△ 217	B 737 - BBJ2	40°53'46,46"	009°30'14,82"
⤷ 218	FALCON 900 B	40°53'43,03"	009°30'16,94"
⤷ 219	GULFSTREAM V	40°53'46,49"	009°30'16,82"
⤷ 220	B 737 - BBJ	40°53'44,15"	009°30'20,21"
⤷ 221	GULFSTREAM V	40°53'47,37"	009°30'18,46"
⤷ 222	B 737 - BBJ	40°53'44,15"	009°30'20,21"
⤷ 223	GULFSTREAM V	40°53'48,25"	009°30'20,11"
⤷ 224	B 737 - BBJ	40°53'44,92"	009°30'21,65"
⤷ 225	GULFSTREAM V	40°53'49,12"	009°30'21,75"
⤷ 226	GLOBAL EXPRESS	40°53'47,92"	009°30'21,83"