

AERODROME GROUND MOVEMENT
AND AIRCRAFT PARKING CHART - ICAO

START 125.200

CHELYABINSK, RUSSIA

BALANDINO

PZ - 90.02 coordinates

STAND NR	LATITUDE	LONGITUDE
1	55 17 55N	061 30 41E
2	55 17 56N	061 30 40E
3	55 17 57N	061 30 41E
4	55 17 59N	061 30 41E
5	55 18 00N	061 30 41E
6	55 17 54N	061 30 47E
7	55 17 55N	061 30 46E
8	55 17 57N	061 30 46E
9	55 17 58N	061 30 47E
10	55 17 59N	061 30 47E
11	55 17 54N	061 30 52E
12	55 17 55N	061 30 52E
13	55 17 58N	061 30 53E
14	55 17 54N	061 30 57E
15	55 17 55N	061 30 58E
16	55 17 56N	061 30 58E
17	55 17 58N	061 31 01E
25	55 17 58N	061 31 06E
26	55 17 56N	061 31 07E
27	55 17 57N	061 31 33E
28	55 18 03N	061 31 30E

Not to scale

APRON:

Surface: 1-10 - Concrete
11-17 - Asphalt
Strength: 1-10 - PCN 27/R/B/W/T
11-17 - PCN 30/R/B/X/T mixed

TAXIWAYS:

Width: 1, 3, MAIN 1 - 22.5m
4 - 18.0m
5, MAIN 2 - 17.5m
Surface: 1, 3 - Concrete
4, 5, MAIN 1, 2 - Asphalt-Concrete
Strength: 1, 3 - PCN 60/R/A/W/T
4, MAIN 2 - PCN 38/R/B/X/T mixed
5 - PCN 37/R/B/X/T mixed
MAIN 1 - PCN 49/R/B/X/T mixed

WARNING:

- Taxiing of index 5, 6 ACFT along TWY 4; of index 4, 5 ACFT along TWY 5, MAIN TWY 2 (from TWY 4 to the apron) shall be carried out at reduced speed, strictly along the centre line, at idle power.
- Taxiing of all ACFT types along MAIN TWY 1 in the day-time shall be carried out strictly along the centre line. When visibility is less than 2000m in the day-time, taxiing of ACFT shall be carried out after the "FOLLOW ME" vehicle. Taxiing of class 1 and 2 ACFT in the night-time and of other ACFT on flight crew's request shall be carried out after the "FOLLOW ME" vehicle.
- Taxiing of all ACFT types on the apron shall be carried out at reduced speed, strictly along the centre line marking. The minimum radius of turn during taxiing on the apron is 22m.
- ACFT parking on stands 28, 29 shall be facing east or facing west. When these stands are vacant, MAIN TWY 1 between TWY 4 and TWY 5 is AVBL for taxiing.

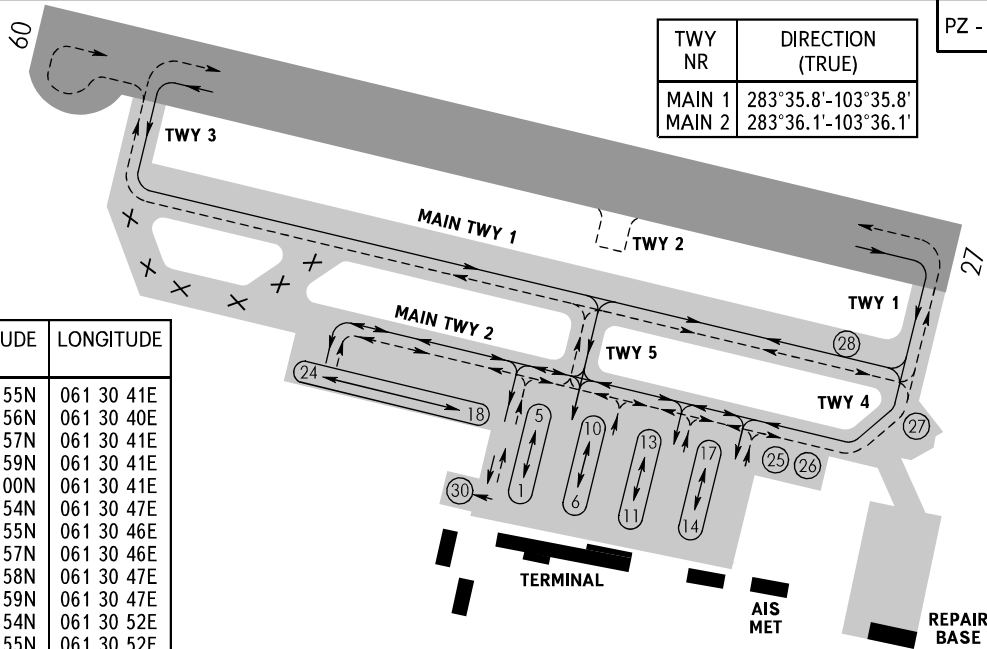

TWY NR	DIRECTION (TRUE)
MAIN 1	283°35.8'-103°35.8'
MAIN 2	283°36.1'-103°36.1'

STANDS:

Surface: 27 - Concrete
11-26, 28-30 - Asphalt
Strength: 18-23 - PCN 45/R/B/X/T
24, 30 - PCN 7/F/C/Z/U
25, 26 - PCN 30/F/B/X/T
27 - PCN 31/R/B/W/T
28 - PCN 49/R/B/X/T

STANDS:

28 - An-124-100, Il-86, Il-62, B747-400, B747-8 B767-300, B777-200, B777-200ER
2, 3, 5, 7-9, 11-15, 17-23, 27, 28 - A-319-100, A-320-100, A-320-200, A-321-100
5, 28 - A-310-200
5, 27, 28 - Tu-204
5, 7-9, 11-14, 17-23 - Tu-154
1-5, 7-23, 25-28 - Tu-134, RRJ-95
3, 5, 7-9, 11-14, 17-23 - Il-18
2-5, 7-9, 11-15, 17-23, 25-28 - Il-114
27, 28 - Il-76, B767-200
5, 13, 17-23, 27, 28 - B757-200
2-5, 7-9, 11-15, 17-23, 27, 28 - B737-200, B737-300, B737-400, B737-500
2, 3, 5, 7-9, 11-15, 17-23, 27, 28 - B737-600, B737-700, B737-800
1-5, 7-23, 25, 26 - An-148
2, 3, 5, 7-9, 11-15, 23 - An-72, An-74
2-5, 7-23, 25, 26 - An-28, An-30, An-32
2-5, 7-23 - An-24, An-26, EMB-120, ATR-42, ATR-72
5, 13, 17-22 - An-12
1-5, 7-17 - Cessna-750, Gulfstream 5, Falcon-900 and class below ACFT
2, 3, 5, 7-9, 11-15, 17-23, 25, 26 - Yak-42
1-23, 25, 26 - Yak-40
1-5, 7-23 - CRJ-100, CRJ-200, RJ-85, SAAB-340B, SAAB-2000
1-5, 7-10, 12, 13, 15-23 - L-410
20 - An-2
30 - DV-20 KATANA
17, 27, MAIN TWY 2 between TWY 4 and TWY 5 - Mi-26, Mi-10K, Mi-6 HEL
16-23, MAIN TWY 2 between TWY 4 and TWY 5 - Mi-8 HEL
16-23 - Mi-2, Ka-26 HEL
23 - sanitary stand for ACFT
24 - sanitary stand for special motor transport
28 - reserve stand for all aircraft types

CHANGE: ACFT, stands, COM