

ARP
55°35'57"N
037°16'23"E

ELEV
209.0

TAXIING 1 120.450
TAXIING 2 121.700
TOWER 118.300

DELIVERY 131.800 (VNUKOVO I and VNUKOVO II)
TAXIING 131.125 (Outside VNUKOVO I and VNUKOVO II)
VIPOORT 122.875 (VNUKOVO III)

PZ - 90.02 coordinates

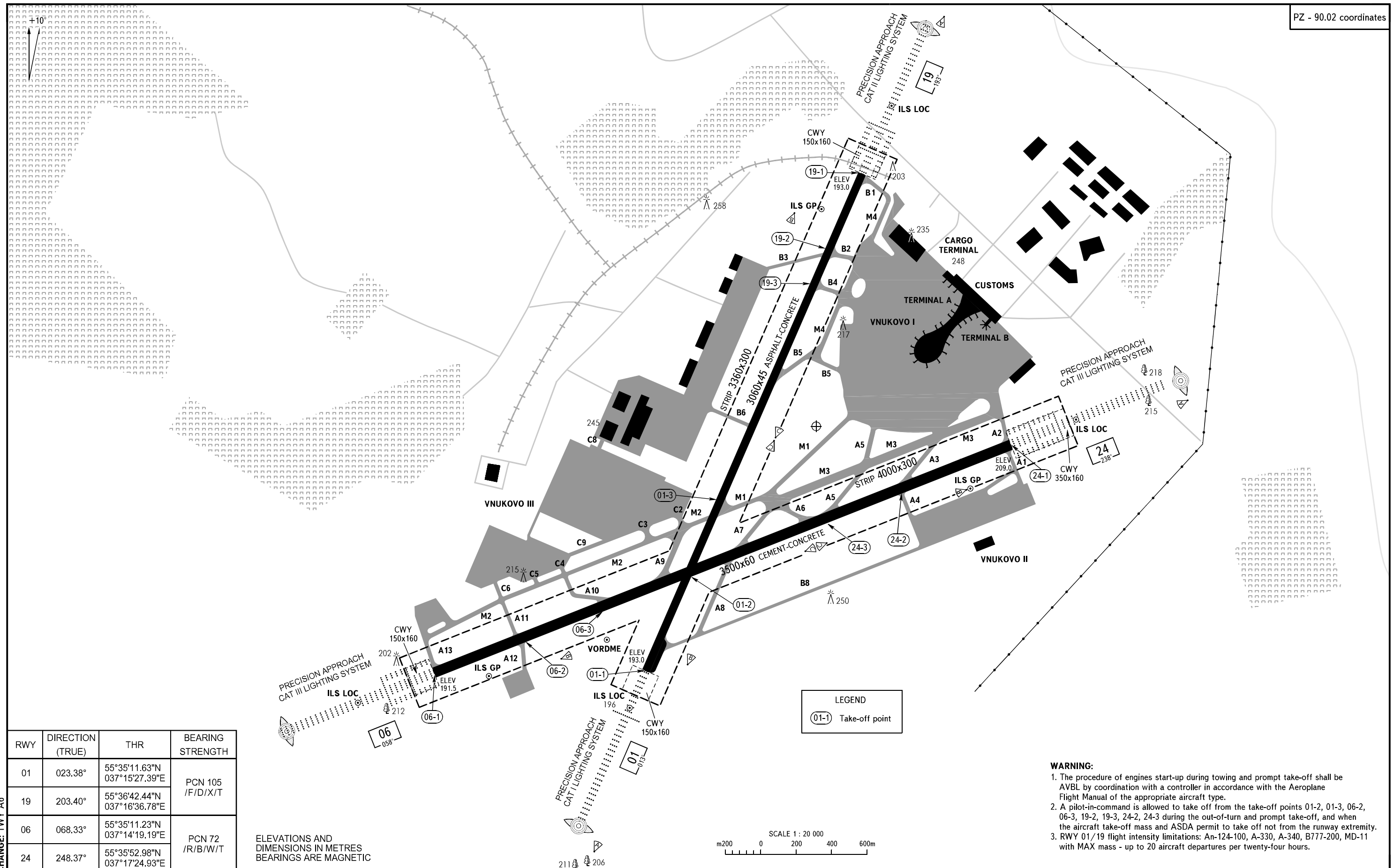

RWY	DIRECTION (TRUE)	THR	BEARING STRENGTH
01	023.38°	55°35'11.63"N 037°15'27.39"E	PCN 105 /F/D/X/T
19	203.40°	55°36'42.44"N 037°16'36.78"E	
06	068.33°	55°35'11.23"N 037°14'19.19"E	PCN 72 /R/B/W/T
24	248.37°	55°35'52.98"N 037°17'24.93"E	

ELEVATIONS AND DIMENSIONS IN METRES
BEARINGS ARE MAGNETIC

- WARNING:**
- The procedure of engines start-up during towing and prompt take-off shall be AVBL by coordination with a controller in accordance with the Aeroplane Flight Manual of the appropriate aircraft type.
 - A pilot-in-command is allowed to take off from the take-off points 01-2, 01-3, 06-2, 06-3, 19-2, 19-3, 24-2, 24-3 during the out-of-turn and prompt take-off, and when the aircraft take-off mass and ASDA permit to take off not from the runway extremity.
 - RWY 01/19 flight intensity limitations: An-124-100, A-330, A-340, B777-200, MD-11 with MAX mass - up to 20 aircraft departures per twenty-four hours.

CHANGE: TWY A6